



Caution

Before you take the pressure switch into operation, make sure to read these operating instructions thoroughly. In the event of damages due to the non-observance of these instructions, improper operation or use of the switch for purposes for which it is not intended, the warranty becomes null and void. We shall not be held liable for resultant consequential damages. The switch is to be installed and removed by technicians only.

The applicable certified national safety regulations for the operation of pressure measuring devices shall be observed. In the installed condition the respective device-specific requirements on the type of protection must be fulfilled.

- Do not change adjustment of factory-adjusted and paint-sealed switches (screw B and C).
- Screw C was adjusted in the factory, and the adjustment fixed with adhesive. This adjustment may not be changed. Change the switching point with B screw only.
- Adjust upper and lower switching points with the dial (B).
- In case of vacuum: connect P2
- Adjustments as indicated in the instructions, except pressure = vacuum.
- Fasten bracket to switch with original factory-supplied screws only.

Fig. 3 Recommended installation arrangement vertical (factory calibration).

Fig. 4 Horizontal installation arrangement, electrical connections upward. Actual switching points are 11 Pa higher than the scale.

Fig. 5 Horizontal installation arrangement, electrical connections downward. Actual switching points are 11 Pa lower than the scale.



Note

With the safety cover removed, contact with terminals 1, 2 and 3 poses a lethal C hazard (mains power voltage)!

Adjusting of upper/lower switching point (Dial B: For higher switching point [higher pressure] turn in clockwise direction.)

Allow pressure to increase gradually (do not exceed max. pressure limit), adjust desired switching point with dial (B).

Check the upper or lower switching points by raising and lowering the pressure several times and make any necessary adjustments.

Note!

Adjust switch within printed-on scale only!
Do not turn the dial (B) into the area of the black mark  ! [Switching contact changes from NC (1-2) to NO (1-2).1

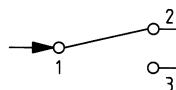
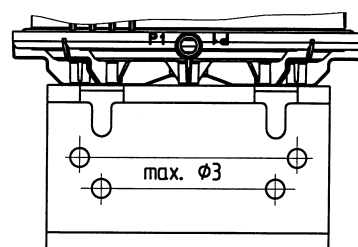
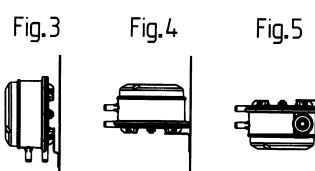
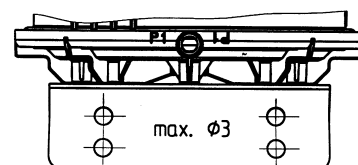
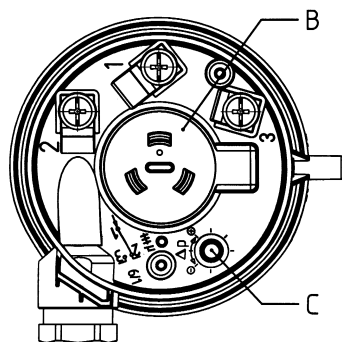
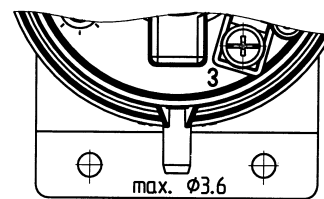
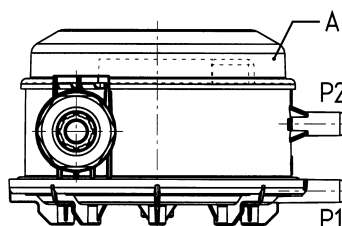

- 1 Supply cable
- 2 NC contact
- 3 NO contact

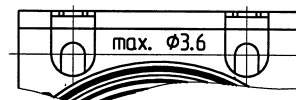

all fixing brackets

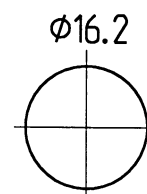
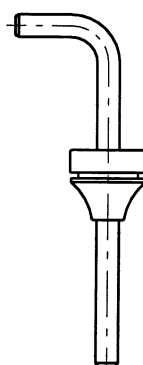
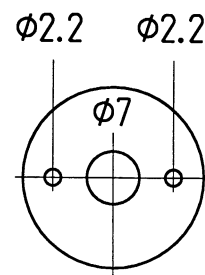
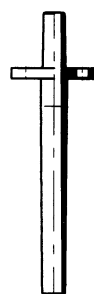

Tube connection