



---

# Pressure Transmitter TP-692

INSTRUCTION MANUAL V1.0x C



Product sold by NOVUS Automation Ltda.

# 1. PRESENTATION

The model **692 Pressure Transmitter** features a unique and proven ceramic sensor, created with cutting-edge technology. The equipment works with a wide range of pressure measurements and features various types of electrical connections and several standard signal outputs. The wide variety of options makes this transmitter ideal for applications across a broad spectrum of the industry.

This model has:

- Very low temperature sensibility;
- High resistance to extreme temperatures.

# 2. IDENTIFICATION

Attached to the equipment is the identification tag. Check if the characteristics described on this label match with were requested.

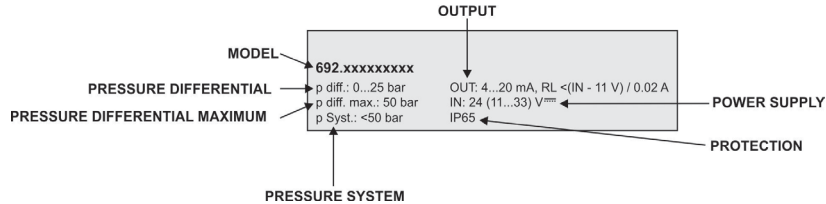

Fig. 01 – Identification Tag

# 3. ELECTRICAL CONNECTION

## 3.1 WIRING DIAGRAM

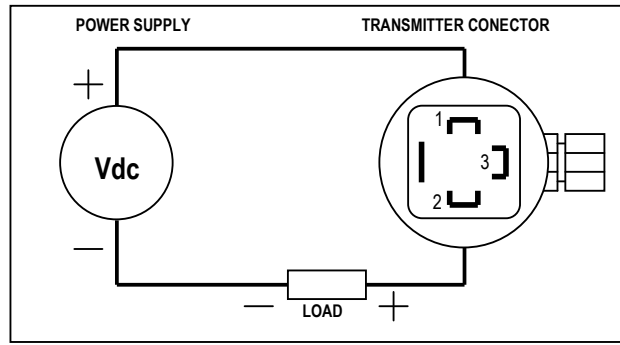

Fig. 02 – Wiring Diagram

The LOAD element in this circuit corresponds to the device indicating the pressure measured by the transmitter, which can be an indicator, a recorder, etc. Its maximum impedance is defined as a function of the voltage value of the POWER SUPPLY.

## 3.2 CONNECTIONS

The equipment has the following wiring diagram:

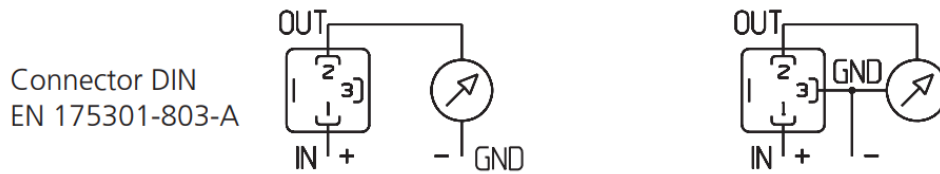

Fig. 03 – Connections

## 4. MECHANICAL CONNECTION

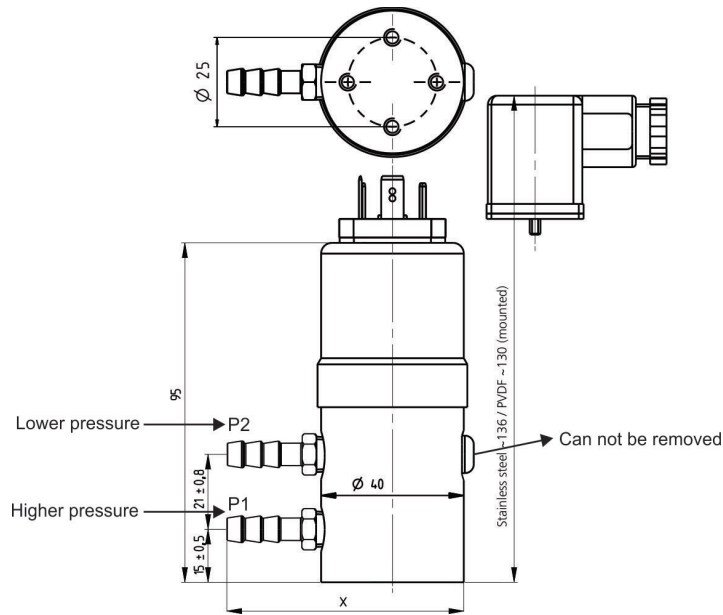

Fig. 04 – Dimensional

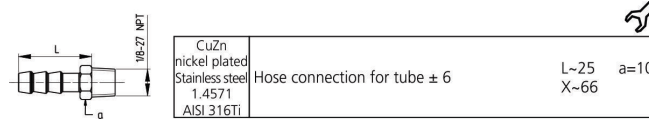

Fig. 05 – Pressure Connector

To attach the tubes to the transmitter, firmly grasp the screw so that it does not rotate.

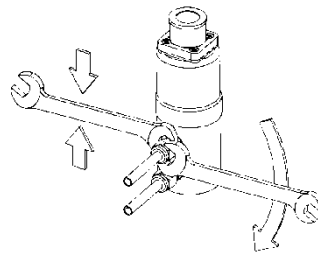

Fig. 06 – Hose Attachment

## 5. ACCURACY

To calculate the maximum error values, the following sum must be performed:

$$\text{Maximum Error} = \text{Tolerance Full Scale Value} + \text{Linearity and Repeatability Error} + \text{Long-Term Stability Error}$$

Parameter	Unit	Versions with overload on one side $\leq 2x$ nominal pressure	Versions with overload on one side $\leq 3x$ nominal pressure	Versions with overload on one side $\leq 7.5x$ nominal pressure
Tolerance zero point (max.)	% FS	$\pm 0.4$	$\pm 0.75$	$\pm 1.25$
Tolerance full scale (max.)	% FS	$\pm 0.4$	$\pm 0.75$	$\pm 1.25$
Resolution	% FS	0.1	0.15	0.25
Total of linearity, hysteresis and repeatability (max.)	% FS	$\pm 0.5$	$\pm 0.75$	$\pm 1.25$
Long term stability (DIN EM 60770)	% FS	$\pm 0.5$	$\pm 0.5$	$\pm 0.5$

Test Conditions: 25 °C, 45 % RH, Power supply 24 Vdc / TC z.p. / TC s. -15 ... +80 °C

Table 01 – Accuracy

## 6. TECHNICAL DATA

<b>Power Supply</b>	11 to 33 Vdc	
<b>Output</b>	4-20 Ma (2 wire)	
<b>Max. Impedance Load</b>	RLmax = (Power Supply - 11 V) / 20 mA	
<b>System Pressure</b>	0...0.1 to 25 bar	
<b>Rupture Pressure</b>	1.5x system pressure	
<b>Operating temperature medium and ambient</b>	-15 to +80 °C	
<b>Dynamic Response</b>	< 5 ms	
<b>Materials in contact with the medium</b>	Sensor: Ceramic Al <sub>2</sub> O <sub>3</sub> (96 %)	
	Pressure connection: Stainless steel 1.4305 / AISI 303; PVDF, CuZn niquelado	
	Sealing material: FPM, EPDM, NBR, MVQ	
<b>Pressure Connection</b>	CuZn nickel plated for pipe outside ± 6 mm	
<b>Electrical Connection</b>	Connector DIN 175301-803-A	
<b>Protection Standard</b>	IP65	
<b>Case</b>	Stainless steel 1.4305 / AISI 303	
<b>Electromagnetic compatibility</b>	CE conformity acc. EN 61326-2-3	
<b>Weight</b>	430 g.	
<b>Accessories</b>	Female connector DIN EN 175301-803-A with seal IP65, when installed and screwed	<b>Order Number</b>
		8832040010

Table 02 – Technical Data

## 7. WARRANTY

Warranty conditions are available on our website [www.novusautomation.com/warranty](http://www.novusautomation.com/warranty).

**EDM Ltd.**

โทรศัพท์ : 02 966 1590 มือถือ : 086 316 7625

Email : contact@edm.co.th LINE : EDM9824